

# CT - 100S

## CONDUCTIVITY / TDS TRANSMITTER

### Features

- On-Line Measurement
- Non Volatile memory retains program settings during power failures
- 4-20 mA DC Output / 4-20 mA with HART (Generic)
- Auto / Manual Temperature Compensation
- On-Line Indication through LCD Display
- Simple Operating Interface
- 2 Wire System

### Description

**E**lectronet series CT-100S are Conductivity transmitters used for various industrial applications. It can accept input from conductivity electrode of cell constant 0.01 / 0.1 / 1 & conductivity signal is transmitted in the form of electrical 4-20 mA signal. The on-line conductivity indication is provided through LCD. Span/Zero adjustments are easily accessible.



### Technical Specifications

Type of Input	From Conductivity Electrode
Cell Constant	0.01 / 0.1 / 1
Calibration Range	Factory Calibrated <b>1</b> 0 to 99.99 $\mu\text{S}/\text{cm}$ for cell constant 0.01
	<b>2</b> 0 to 999.99 $\mu\text{S}/\text{cm}$ for cell constant 0.1
	<b>3</b> 0 to 9999.99 $\mu\text{S}/\text{cm}$ for cell constant 1
Power Supply	24V DC Two Wire Loop Powered
Power Consumption	< 50 mW
Display	Local display LCD with backlit
Type of Output	4-20 mA DC Output / 4-20 mA with HART (Generic)
Electronics Transmitter Accuracy	+/- 0.25% F. S.
Response Time	< 500 mSec
Temperature Coefficient	+/- 0.01% per $^{\circ}\text{C}$
Temperature Compensation	RTD PT-100 / RTD PT-1000
Ambient Conditions	Temperature -20 to 55 $^{\circ}\text{C}$ / Humidity 5 to 95% non condensing
Isolation	1.4 KV between Input, Output & Power Supply
Sensor Connection	1) Through BNC connector 2) Through Terminals
Conduit Entry	1) M20X1.5 (F) 2) 1/2" NPT(F) 3) M12 Connector & 4) Other
Dimensions	155 mm (H) x 105 mm (W) X 130 mm (D)
Mounting	2" Pipe Mounting
Electronic Protection Class	Flame Proof CMR I IIA IIB / Weather Proof IP-67/ Weather Proof IP-54
Housing	Cast aluminum with epoxy coating NEMA 4X / SS316
Weight	1kg (Approximate)
Flow Through Assembly (Optional)	SS316 / PP
Certification	<b>CE</b>

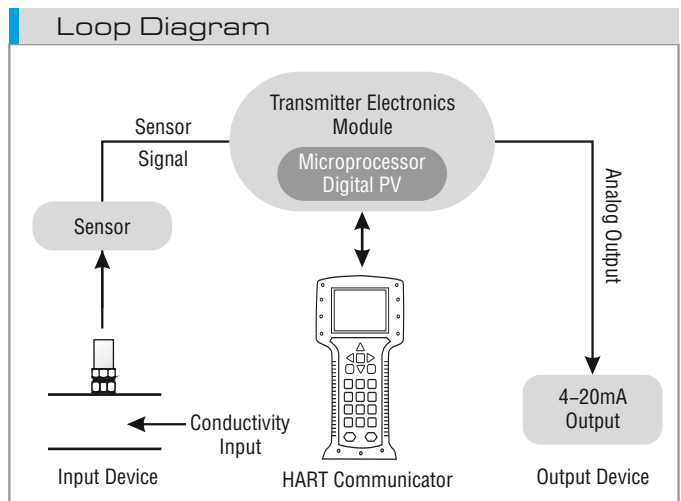
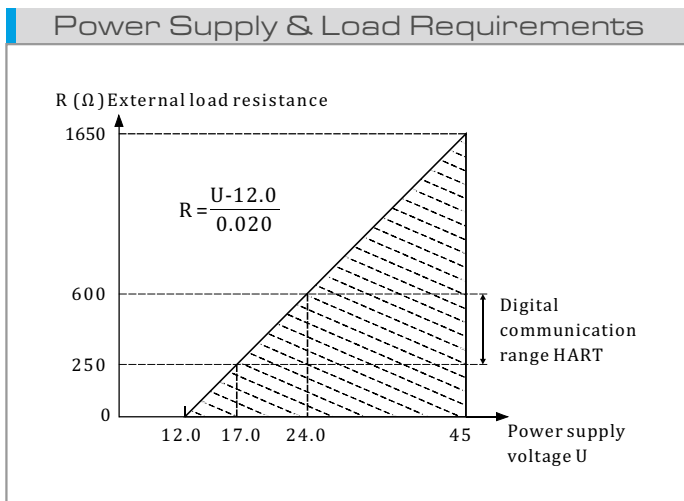
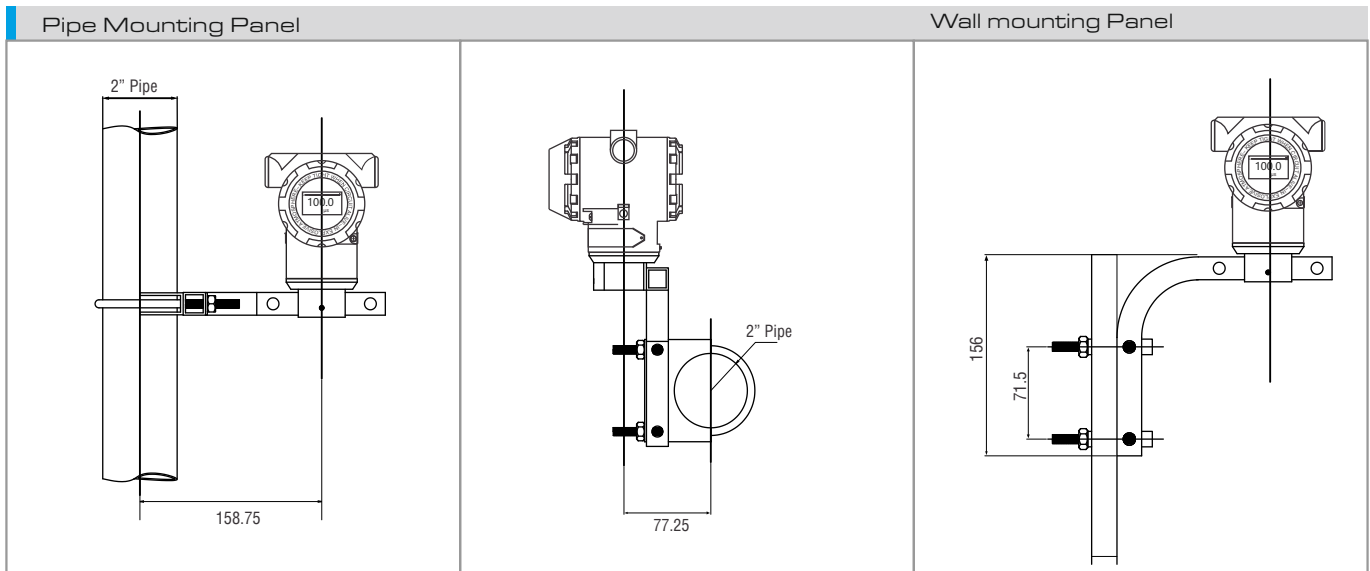

### Ordering Information

Parameter	Code	Description
B	Input 1	B3 Conductivity (Cell Constant 0.01)
		B4 Conductivity (Cell Constant 0.1)
		B5 Conductivity (Cell Constant 1)
		B9 TDS
D	Area Classification (Electronics)	D1 Weather Proof IP54
		D2 Weatherproof IP 67
		D3 Flame Proof CMRI IIA IIB
G	MOC Electronics Enclosure	G1 Die Cast Aluminium
		G2 SS316

Sample Order Code : B3 D2 G1 H2 I1 K1

Parameter	Code	Description
H	Electrical Connection	H1 M 20 x 1.5 (F)
		H2 ½" NPT (F)
		H3 M12 Connector
		HY Other
		I
IY Other		
K	Output 1	K1 4 to 20 mA
		K2 4 to 20 mA with HART (Generic)
		KX NA

Note : Due to our continuous product revisions, design specification and model numbers are subject to change without notice.  
 Accuracy defined at Lab Conditions.  
 For other requirement please consult factory.  
 Sensor & other accessories to be ordered separately.

## ELECTRONET EQUIPMENTS PVT. LTD.

Factory Address:	Registered Office:
Plot No. 8, (SEZ) Phase 1, Kesurdi MIDC, Khandala, Dist.- Satara Pin: 412 801, Maharashtra, India.	Plot No. 84, 85, 86, Tiny Industrial Estate, Kondhwa Budruk, Pune-411 048, Maharashtra, India.

+91-20-26931476/2039    ho@eeplindia.com    +91-20-26934122    www.eeplindia.com